

# Long Reach Riveting And Eyelet Tool Component and Add-on Guide

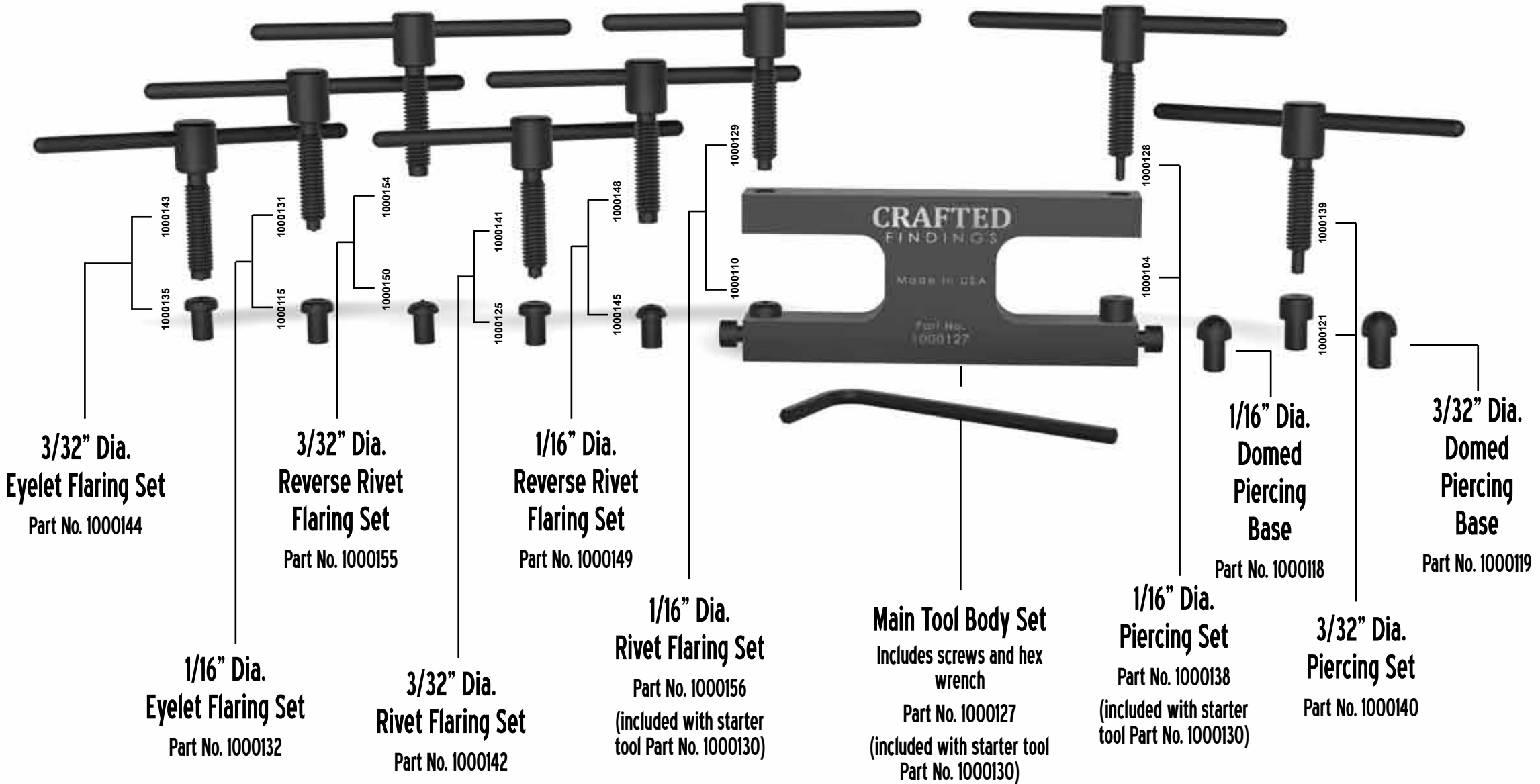

**3/32" Dia.  
Eyelet Flaring Set**  
Part No. 1000144

**1/16" Dia.  
Eyelet Flaring Set**  
Part No. 1000132

**3/32" Dia.  
Reverse Rivet  
Flaring Set**  
Part No. 1000155

**3/32" Dia.  
Rivet Flaring Set**  
Part No. 1000142

**1/16" Dia.  
Reverse Rivet  
Flaring Set**  
Part No. 1000149

**1/16" Dia.  
Rivet Flaring Set**  
Part No. 1000156  
(included with starter  
tool Part No. 1000130)

**Main Tool Body Set**  
Includes screws and hex  
wrench  
Part No. 1000127  
(included with starter tool  
Part No. 1000130)

**1/16" Dia.  
Piercing Set**  
Part No. 1000138  
(included with starter  
tool Part No. 1000130)

**3/32" Dia.  
Piercing Set**  
Part No. 1000140

**1/16" Dia.  
Domed  
Piercing  
Base**  
Part No. 1000118

**3/32" Dia.  
Domed  
Piercing  
Base**  
Part No. 1000119